

NOTES:

- 1.Circuit: ON/OFF
- 2.Operation force: 550±150gf
- 3.Electrical rating: 8A 250VAC ULCUL CQC
15A 125VAC ULCUL CQC
12(6)A 250VAC ENEC
- 4.Contact resistance: <30mΩ
5. Insulation resistance: >100MΩ
(500VDC between open contacts)
- 6.Dielectric strength: >1500V 1 minute
7. Comply with the requitemints of the EU directive
2002/95/EC RoHs and subsequent amendments.
- 8.Life:The switch can satisfy the test standard
of BTP0001 and life requirement of all the puoducts.
- 9.Terminal:#187 TAB Terminal, accord the UL310 standard.
- 10.Satisfy the test requirement of PST-11,switch impact.
- 11.UL file NO. :E300970
- 12.The terminals shouldn't be taken out when the pushing
force is less than 80N and pulling force is less than 98N.

| 品名 | 上盖/基座颜色 | 备注 |
|-----------------------|---------|----|
| RT-S02-117-R4NBR2 D/C | 红色/黑色 | |
| RT-S02-117-R4NBB2 D/C | 黑色/黑色 | |

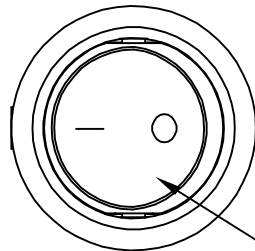

雾面红色上盖

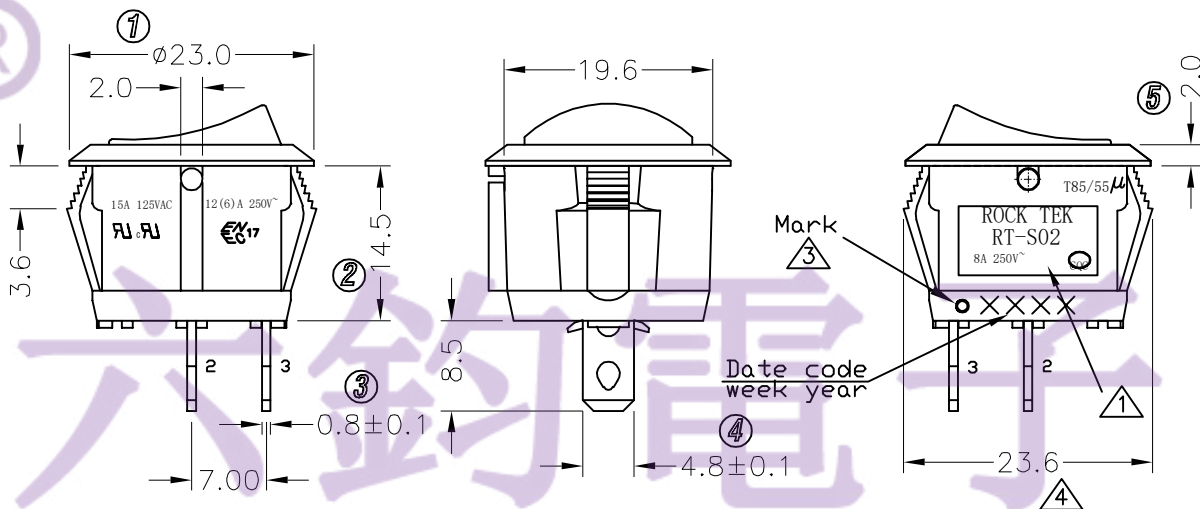

Panel cut out(Thickness: 3mm Max)

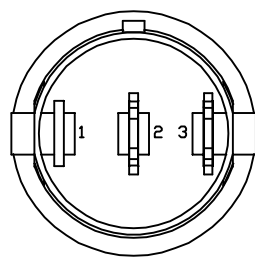
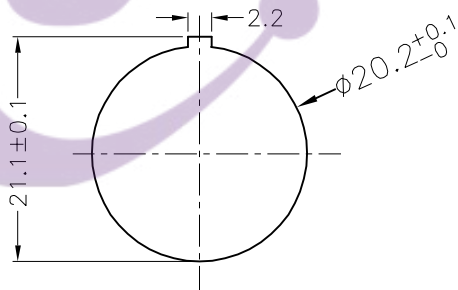

Circuit of Switch

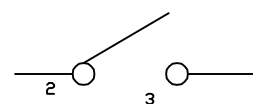

| NO | DESCRIPTION | NO | DESCRIPTION | ANGLES | ±0.5° | 东莞市六钧电子五金有限公司 | | | | RT-S02-117-R4NBB2 D/C | | | |
|----|-------------------|----|-------------|------------------------|-----------|----------------|---------|--------|-------|-----------------------|-----|-------------|-----|
| 5 | 增加黑色上盖 2023.11.17 | 10 | → | DIMENSIONAL TOLERANCES | | APPROVED | CHECKED | DESIGN | DRAWN | ALL SIZE ARE IN | MM | | |
| 4 | 23.4 → 23.6 | 9 | → | RANGE | TOLERANCE | | | | | SCALE | FIT | | |
| 3 | 增加标识 | 8 | → | X | ±0.4 | 2018.06.23 | | | | MAT'L | *** | | |
| 2 | 500±200 → 550±150 | 7 | → | X.X | ±0.3 | | | | | MATERIAL NO. | | DRAWING NO. | REV |
| 1 | 取消VDE | 6 | → | X.XX | ±0.2 | | | | | WIF118012 | | A4 | |